

you can
Canon

iRC2380i
Multifunctional Printer

The cost effective way to
communicate in colour

AT LOWER COSTS.

ADDED
IMPACT.



iRC2380i

COLOUR



COLOUR LEAVES A LASTING IMPACT

Cost effective colour for lasting impact

Communicate in colour for added impact with the incredibly efficient iRC2380i. This compact multifunctional device acts as the central hub for your document communication, enabling you to capture, manage and distribute information at speed and with supreme confidence.

iRC2380i

COLOUR

Space and cost saving colour

Whenever you choose a print device to help improve efficiency around the office, it's important you choose a device that's equipped to do the job, won't consume your budget and won't take up too much office space. Canon's iRC2380i is the intelligent, highly affordable solution, putting productive colour communication at everyone's fingertips in one highly compact multifunctional device.

For cost savings, Canon's Automatic Colour Sensing technology determines whether pages are black and white or colour and prints accordingly - so you only pay for colour when it's used. A fixed cost per page means the cost of colour output doesn't increase with page coverage, and offers cost predictability for peace of mind.

Quick to implement colour

The compact iRC2380i can be housed anywhere - connecting wirelessly to your network (LAN) and ready to go in minutes. Managing the device is equally simple using Canon's web-based iW Management Console (iWMC). Numerous devices can be centrally managed with features such as central control of remote devices, new device discovery, and device error notifications (e.g. out of toner) via automated email.

Easily controllable colour

A number of powerful tools exist which allow you to keep a tight reign on your costs. Canon's optional iWAM MEAP software is a management tool that allows you to easily determine who is printing what, where and how much it's costing you.

The new AMS feature included within Canon's uniFLOW Output Manager allows you to set specific profiles for individuals or departments. For example, certain departments or individuals can be restricted to only black and white prints, whilst others can print in full colour. This helps you to manage resources in line with business needs and keep costs to a minimum.

Always-efficient colour

Canon's unique e-Maintenance automatically reports any problems to service centres and Canon partners, so you don't need to worry about constant monitoring.

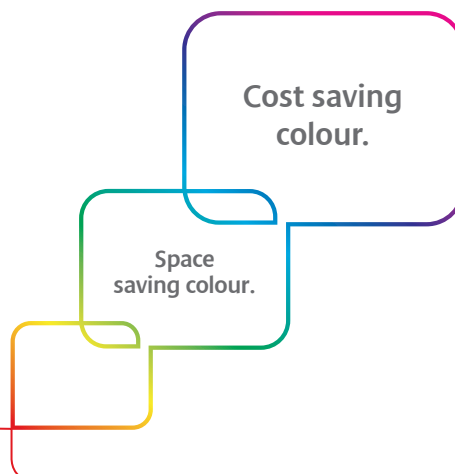

Use the multifunctional iRC2380i to create a highly efficient flow of succinct, informative and impactful communication throughout your business. This wireless network device occupies little room but delivers big results – with colour print, copy, fax, scan and send facilities managed in one powerful system.

Quality and performance within your budget

Productive prints

The iRC2380i delivers impressive performance for such a compact, affordable device. Count on high quality prints at 23 ppm – whether you're printing in colour or black and white.

Professional quality prints

Bring new levels of professionalism to your document communication. Canon's high quality toner ensures a uniform distribution of colour onto every page, with a professional matt finish. A varied range of accessories allows you to create all manner of output including booklets, stapled reports and hole-punched documents. And thanks to Canon's innovative 4-colour drum technology, even heavier media can be used for added impact.

New ways to communicate

Open up a new world of communication possibilities with the iRC2380i. Scan and send documents instantly from the MFP to a range of destinations, including e-mail, network folders or Mailboxes. Mailboxes act as secure storage at the device for all documents, and can be established for individuals and groups of users. Any document can be scanned, sent to, or printed directly from a mailbox at your convenience – handy if you don't want a confidential report lying around before you have a chance to retrieve it. You can also preview documents in your mailbox at the device before printing.

Improve document workflow with iW360

Using Canon's innovative iW360 software solution, any document based workflow or process is easier to achieve. From manuals to sales tools, proposals to reports, iW360 enables you to produce professional documents and manage a multitude of data in minutes.

Protect your assets

The iRC2380i provides device access control by passwords, company log-in procedures or even fingerprints! Documents can be held in secure mailboxes until the relevant user is ready to print for watertight security. Scanned documents can also be encrypted before sending to others or a secure watermark can be embedded into a printed document, becoming prominent when someone attempts to make a copy. Network authentication tools ensure that only authorised PCs can communicate with the iRC2380i. Plus, device hard disks can be erased or encrypted, and "job logs" concealed.

The iRC2380i (along with the HDD Data Encryption Kit) also qualifies for EAL3 status under the Common Criteria Program (ISO15408): the global standard for IT security evaluations.



COLOUR LEAVES A LASTING IMPACT



Secure
communication.

Quality
results.

Next-generation features for professional-standard results

The range of finishing options on the iRC2380i means you can produce professional documents quickly and easily without the hassle and expense of outsourcing.

From simple documents to professional finishing

Making your documents look like the real deal is easy with the iRC2380i.

1 With no more than a few simple mouse clicks, and the Saddle Finisher Y2, you can produce automatically folded A5 and A4 booklets. (Buffer Pass Unit E2 is required).

2 Increase productivity by adding hole punch capability to the functionality of the finisher. 2 or 4 hole options are available.

3 For extra copies or heavier workloads, the Finisher Y1 is ideal with its two trays and a 2,000 sheet capacity. It also accommodates 50 sheet stapling for larger report production. (Buffer Pass Unit E2 is required.)

- 1** Saddle Finisher Y2*
- 2** Hole Puncher Unit*
- 3** Finisher Y1*
- 4** DADF L1*
- 5** Internal Finisher Z1*
- 6** Advanced Technology
- 7** Paper Cassette
- 8** Cassette Feeding Unit Y3*
- 9** Stack Bypass
- 10** Side Paper Deck Z1*

* Optional



4 A 50 sheet document feeder (DADF) helps scan and copy multi page documents quickly and easily, and can accommodate different size originals.

5 Transform a simple colour report into a fully stapled document with the optional internal Finisher Z1. Staple capacity is 50 sheets of A4, with a capacity of 500 A4 – A5R in a single print run.

6 Using the Multifunctional Embedded Application Platform (MEAP), Canon's Java based application platform, enables new and customised software to be incorporated directly within your device. This way you can future proof your investment. Plus, the device also adheres to the strictest environmental standards such as RoHS, which restricts the use of hazardous substances.

7 Two cassettes are equipped as standard. Each of the 550 sheet cassettes are user-adjustable to cope with paper sizes between A5 – A3+.

8 A total of 4,950 sheets gives huge versatility from 6 different sources, including optional additional trays, allowing you to produce stunning colour documents combining different media types and weights.

9 The 50 sheet stack bypass accommodates a variety of media up to 220gsm.

10 Configure the iRC2380i with the 2,700 sheet paper deck and you have a comprehensive paper supply equipped for the most demanding workloads.

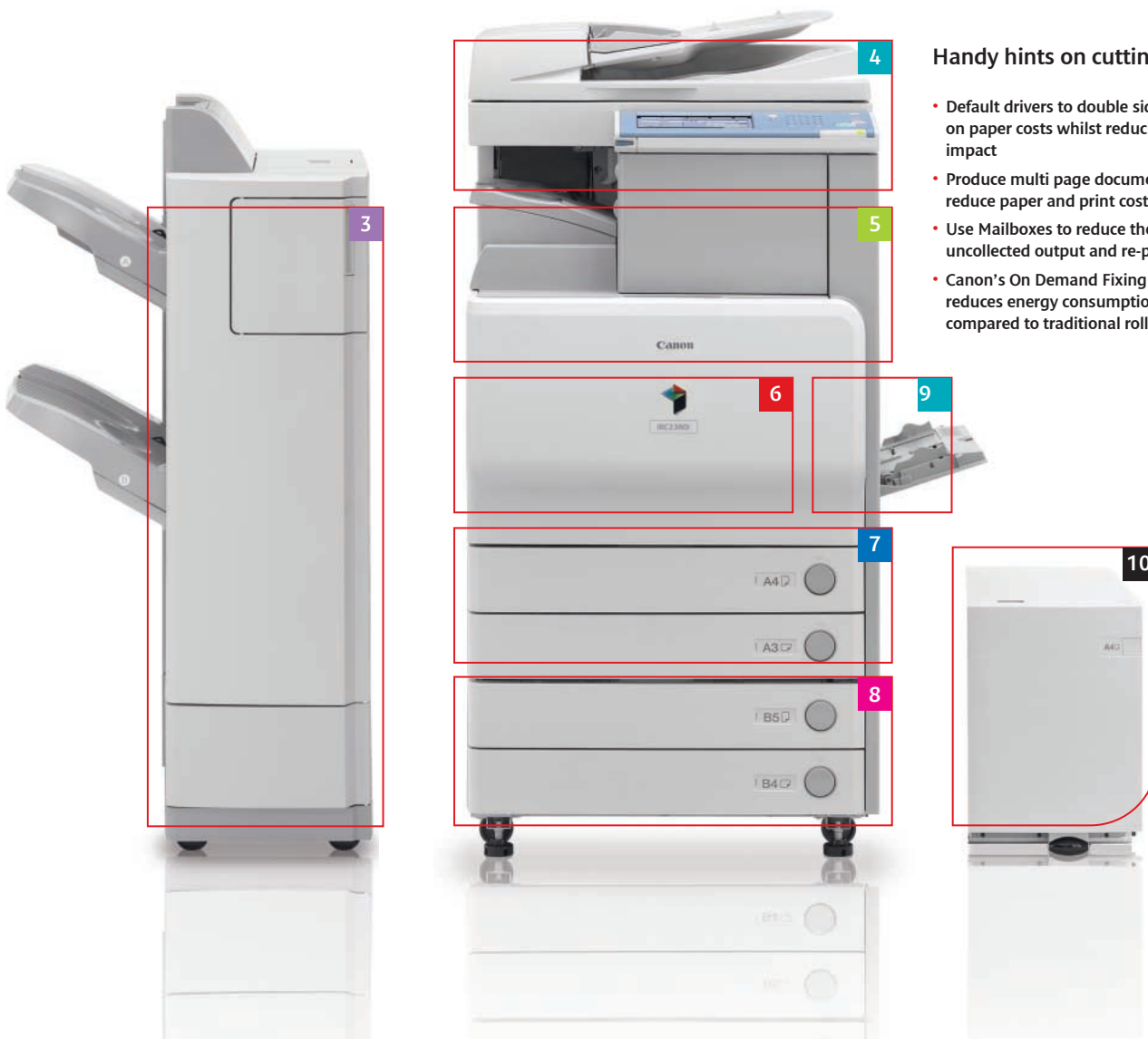

Handy hints on cutting costs

- Default drivers to double sided and save 40% on paper costs whilst reducing environmental impact
- Produce multi page documents as booklets to reduce paper and print costs by 50%
- Use Mailboxes to reduce the cost of uncollected output and re-prints
- Canon's On Demand Fixing Technology reduces energy consumption by up to 75% compared to traditional roller fixing methods

Specifications iRC2380i

Type	Desktop
Maximum Original Size	A3
Copy Sizes	305 x 457mm, A3, A4, A4R, A5R
Cassette	A5R - SRA3 (320 x 450mm), Envelopes
Stack Bypass	99 x 140mm to 320 x 457mm
Resolution	600dpi x 600dpi
Reading	600dpi x 600dpi
Copying	1200dpi x 1200dpi (Text/Line only, Half Speed, Optional for iRC2380i)
Printing	256 Gradations
Copy/Print Speed	
A4	23ppm B&W 23ppm full colour
A3	15ppm B&W 15ppm full colour
Magnification	
Zoom	25-400%
Fixed	25%, 50%, 71%, 100%, 141%, 200%, 400%
First copy time	5.9 seconds
Black-and-White	8.9 seconds
Full Color	38 seconds
Warm-Up Time	1 to 999 sheets
Multiple Copies/Prints	Standard automatic stackless
Duplexing	
Paper weight	
Cassette	64 to 163g/m ²
Stack Bypass	64 to 220g/m ²
Duplex	64 to 105g/m ²
Paper Capacity	
Standard	550 sheets x 2 cassettes (80g/m ²) Stack Bypass: 50 sheets (80g/m ²) 550 sheets x 2 cassettes (80g/m ²)
Optional	2,700 sheets (80g/m ²)
Paper Deck	4,950 sheets
Total capacity	Canon Custom Processor, 533MHz+400MHz
CPU	1.5Gb
Memory	80Gb
Hard Disk Drive	Ethernet (100Base-TX/10Base-T), Wireless LAN (IEEE802.11b/g, Optional), USB2.0
Interface	220-240V AC, 50/60Hz
Power Supply	1.5 kW max.
Power Consumption	565 x 760 x 791mm
Dimensions (W x D x H)	Approx.116kg
Weight	
COLOUR UFR II/PCL PRINTER KIT-Q3	
PDL	(Standard for iRC2380i) PCL5c, PCL6, UFR II
Resolution	1200dpi x 1200dpi (Text/Line only, Half Speed, Optional for iRC2380i), 600dpi x 600dpi
Memory	1.5Gb, Uses Main Unit HDD
Hard Disk	80Gb (Uses Main unit HDD)
CPU	533MHz & 400MHz (Uses Main unit CPU)
PS Fonts	Roman136
PCL Fonts	Roman80, Bitmap1, OCR2
Supported OS	Windows 2000/XP/Server2003/Vista Windows 2000/XP/Vista Windows 2000/XP/Server2003/Vista, Mac OSX (10.2.8 or later)
PCL5c	Ethernet (100Base-TX/10Base-T), Wireless LAN (IEEE802.11b/g, Optional), USB2.0
PCL6	
UFR II	
Interface	
Network Protocol	TCP/IP(LPD/Port9100/IPP/PPS/SMB/FTP), IPv6, IPX/SPX (NDS, Bindery), AppleTalk
Pull Scan	Network TWAIN Driver (75 to 600dpi 24 bit color /8 bit grayscale/ Black & white)
COLOUR PS PRINTER KIT-Q3	
PDL	PostScript3 Emulation
Resolution	1200dpi x 1200dpi (Text/Line only, Half Speed, Optional for iRC2380i), 600dpi x 600dpi
PS Fonts	Roman136
Supported OS	Windows 2000/XP/Server2003/Vista, Mac OSX (10.2.8 or later)
PS	Mac OSX (10.2.8 or later)
Mac-PPD	
COLOUR UNIVERSAL SEND KIT-N1	
Scan Speed	(Standard for iRC2380i) A4 44 ipm 300dpi (Colour/B&W) with DADF
Scan Resolution	100dpi, 150dpi, 200 x 100dpi, 200dpi, 200 x 400dpi, 300dpi, 400dpi, 600dpi
Destinations	E-Mail/Internet FAX (SMTP), PC (SMB, FTP, NCP), iWDM (FTP), WebDAV
Address book	LDAP, Local (Max.1800)
File Format	Single page - TIFF, JPEG, PDF Multi page - TIFF, PDF

UNIVERSAL SEND PDF ADVANCED FEATURE SET-A1	Format	PDF - High Compression PDF, Searchable PDF (OCR), Scalable PDF (Trace and Smooth)
UNIVERSAL SEND PDF SECURITY FEATURE SET-A1	Format	PDF - Encrypted PDF, PDF with device signature.
DADF-L1	Paper size	A3, A4, A4R, A5, A5R
	Paper weight	42 to 128g/m ²
	Single sided original	50 to 128g/m ²
	Double sided original	50 sheets (80g/m ²)
	Max. number of originals	
	Docu Scanning speed (max.)	A4 28 ipm 600dpi (Colour/B&W)
	Copy	A4 44 ipm 300dpi (Colour/B&W)
	Scan	565 x 538 x 122mm
	Dimensions (W x D x H)	Approx. 8.5kg
	Weight	
CASSETTE FEEDING UNIT-Y3	Type	2 Front-loading adjustable drawers
	Paper Size	305 x 457mm, A3, A4, A4R, A5R
	Paper Weight	64 to 163g/m ²
	Paper Capacity	550 sheets x 2 cassettes (80g/m ²)
	Dimensions(W x D x H)	565 x 700 x 251.5mm
	Weight	Approx. 23kg
PAPER DECK-Z1	Paper Size	A4
	Paper Weight	64 to 105g/m ²
	Paper Capacity	2,700 sheets (80g/m ²)
	Dimensions(W x D x H)	372 x 591 x 473mm
	Weight	Approx. 30kg
FINISHER-Z1	Number of trays	One stack tray (Inner)
	Tray capacity	A4, A5, A5R, A4-A5R: 500 sheets A3, A4R, A3: 250 sheets
	Staple position	Corner, Double
	Staple capacity	A4: 50 sheets, A3: 30 sheets
	Dimensions (W x D x H)	493 x 550 x 217mm
	Weight	Approx. 13.1kg
FINISHER-Y1/SADDLE FINISHER-Y2	Number of trays	2 Trays
	Tray capacity	A4, A5, A5R: 1,000 sheets Max (A4) A3, A4R: 500 sheets Max (A4)
	Staple position	Corner, Double, Saddle Stitch (Y2 only)
	Staple capacity	A4: 50 sheets (80g/m ²) A3, A4R: 30 sheets (80g/m ²)
	Saddle Stitch Specifications (Saddle Finisher-Y2 only)	
	Paper size	305 x 457mm, A3, A4R
	Staple capacity	1 to 15 sheets (60 pages, 64-80g/m ²) 1 to 10 sheets (40 pages, 81-105g/m ²)
	Dimensions (W x D x H)	Y1: 643 x 657 x 1073mm Y2: 747 x 657 x 1073mm
	Weight	Y1: 43.6kg Y2: 73.6kg
OTHER ACCESSORIES		Direct Printing Kit-F1, Barcode Printing Kit-A1, Web Access Software-E1, Secure Watermark-A1, Encrypted Printing Software-C1, HDD Data Erase Kit-A1, HDD Data Encryption Kit-B1, Digital User Signature PDF Kit-A1, Super G3 FAX Board-W2, IR3100C pedestal, Platen Cover Type H, Inner 2Way Tray-D1, Buffer Pass Unit-E2 (For Finisher-Y1/2), Copy Tray-J1, Puncher Unit-L1/N1, ADF Access Handle-A1, Remote Operators Software Kit-A2, Voice Guidance Kit-B1, Voice Operation Kit-A1, Document Tray-J1, Key Switch Unit-A2, Card Reader-C1, Card Reader Attachment-B1, Wireless Network Interface Adapter NB-W1, 1200dpi Print Expansion Board-A1
Some images are simulated for clarity of reproduction. All data is based on Canon's standard testing methods. This leaflet and the specifications of the product have been developed prior to the date of product launch. Final specifications are subject to change without notice.™ and ®. All company and/or product names are trademarks and/or registered trademarks of their respective manufacturers in their markets and/or countries. Canon Recommends you use Canon Media for the best results. Please check media (paper) compatibility list to see which variety of paper/media is recommended. Canon's GENUINE logo means Quality all-round performance. For more information, go to www.canon-europe.com/Canon_Copier_Consumable_Technology		

you can
Canon

Canon Inc.
www.canon.com

Canon Europa N.V.
www.canon-europe.com

English UK Edition
© Canon Europa N.V., 2008

Canon (UK) Ltd
Woodhatch, Reigate
Surrey RH2 8BF

Telephone No: 08000 353535
Facsimile No: 01737 220022
www.canon.co.uk



POWERED BY



EMaintenance

Canon Ireland
Arena Road, Sandyford
Industrial Estate
Dublin 18, Ireland
Telephone No: 01-2052400
Facsimile No: 01-2958141
www.canon.ie